

# WrightWall Natural<sup>2</sup> panel system

*Natural, breathable wall panel system*

Elements  
by OAKWRIGHTS®

## Overview

WrightWall Natural<sup>2</sup> is a breathable timber frame wall panel system designed to support sustainable, high performance construction. Made from natural materials and engineered with precision, it offers excellent thermal performance, thermal mass, moisture regulation, and ease of onsite installation.

Ideal for energy efficient projects requiring natural building materials without compromising on quality or construction timelines.

## Features

### Breathable construction:

Allows moisture to pass through the wall system, reducing risk of condensation and improving indoor air quality.

### Natural materials:

Built using STEICOzell woodfibre insulation and responsibly sourced timber.

### Modern methods of construction:

Pre-fabricated under workshop-controlled conditions for accuracy, speed, and reduced site waste.

### Sustainable and low carbon:

Insulation made from fresh conifers from regional sustainable forests, this product is approximately 81% woodfibre.

### High thermal efficiency:

Low U-values achieving passive house levels of airtightness.

### Fast efficient installation:

Delivered in large, pre-insulated panels for rapid assembly and weather tightness. They can also be supplied with joinery already installed.

Choice of external finish  
(brick / cladding / render)

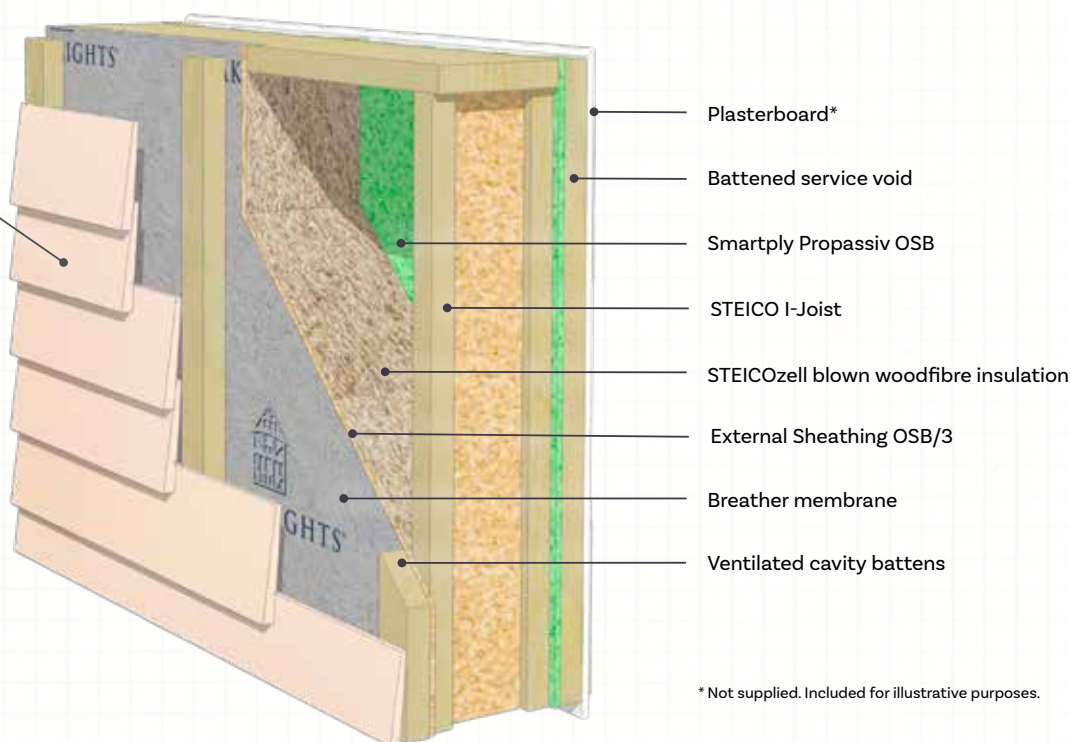

\* Not supplied. Included for illustrative purposes.

# Wall Build-Up

Layer	Description
Battened service void	Provides space for internal services.
Smartply Propassiv OSB	Structural board with integrated vapour control; ideal for energy efficient and Passive House builds.
STEICO I-joist	High strength engineered structural element offering versatility and superior load bearing for walls and roofs.
STEICOzell blown woodfibre insulation	Natural blown STEICOzell insulation with excellent thermal performance and moisture regulation.
External sheathing OSB/3	Structural panel adding rigidity and strength to wall and roof systems.
Breather membrane	Water resistant and vapour-permeable membrane protecting the panels during and after construction while allowing moisture to escape.
Ventilated cavity	Creates the required air gap for ventilation.

Please note: all the components listed above are fully assembled in our workshop and delivered to site ready for erection. While all internal and external finishes will be installed by others onsite.

## Performance Data

Property	Value / Information
U-value (Typical)	0.14W/m²K
Airtightness	Achieves airtightness levels below Passive House levels (<0.6 ACH), when installed in conjunction with a suitable ventilation system.
Panel Thickness (Typical)	308 mm inc. internal and external battens (not including external and interior finishes).
Fire Resistance	Fire approved to BS EN 1365-1:2012 (load bearing wall) and BS EN 1363.1:2020.
Vapour Permeability	Highly breathable system / the assessment reveals no risk for condensation within the build-up.
Embodied Carbon	Significantly lower than conventional wall systems.

## Compliance & Compatibility

- **Compatible with:** Oakwrights WrightRoof Natural² system, AeroBarrierUK and Oakwrights products portfolio.
- **Standards:** Designed to exceed UK Building Regulations.
- **STA Assure Gold certified.**

### Uses

- Bespoke residential and commercial projects
- Passive house homes
- Energy efficient developments

### Why Choose WrightWall Natural²?

- Designed and manufactured by Oakwrights’ with over 25 years’ experience in the construction industry.
- An In-house tech department to assist on all complex projects.
- Balances innovation, performance, and sustainability.
- Supports airtight, breathable, healthy energy efficient home design.
- Supported by a range of fully developed products and services inc. Joinery.